

- Using a thin flexible saw, remove the two molded standoffs on the tender undercarriage that previously supported the tender electronics PCB (refer to photo #3 and photo #4).

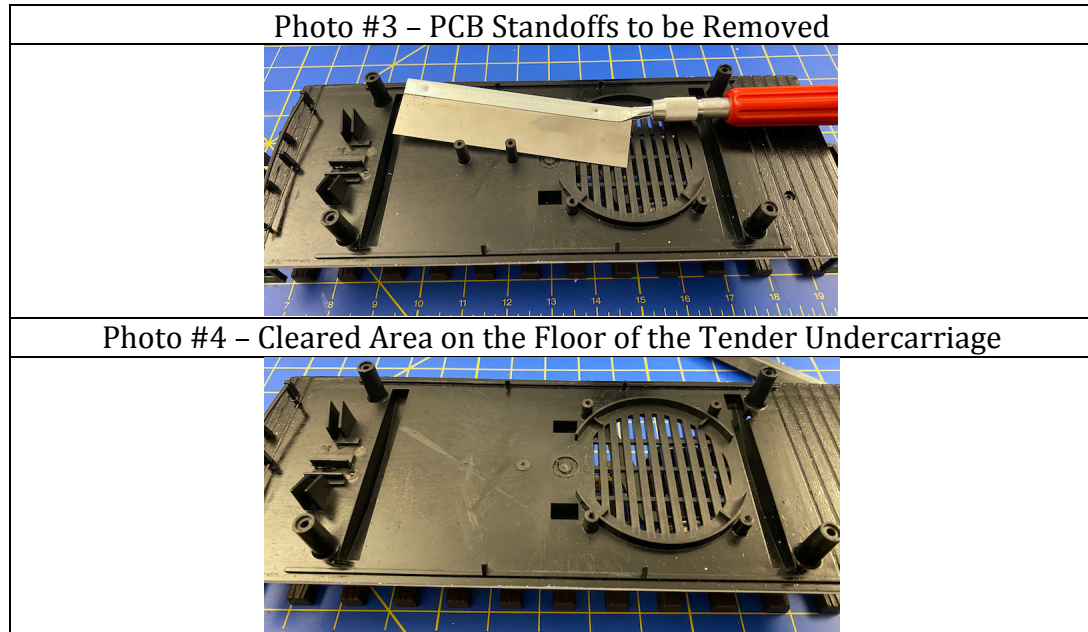

- Apply Velcro to the cleared area on the floor of the tender undercarriage and the Lithium-Ion battery pack (refer to photo #5).



- Using one male and one female JST SM connection extend the Lithium-Ion battery pack connection through the tender undercarriage. Solder the appropriate connections (black to black and red to red) and protect them with heat shrink tubing (refer to photo #6). Use a small cable tie to secure the wire assembly to the tender undercarriage (refer to photo #7). Remember to trim any excess length from the cable tie.